

Steri-Tamp® Vial & Bottle Instructions

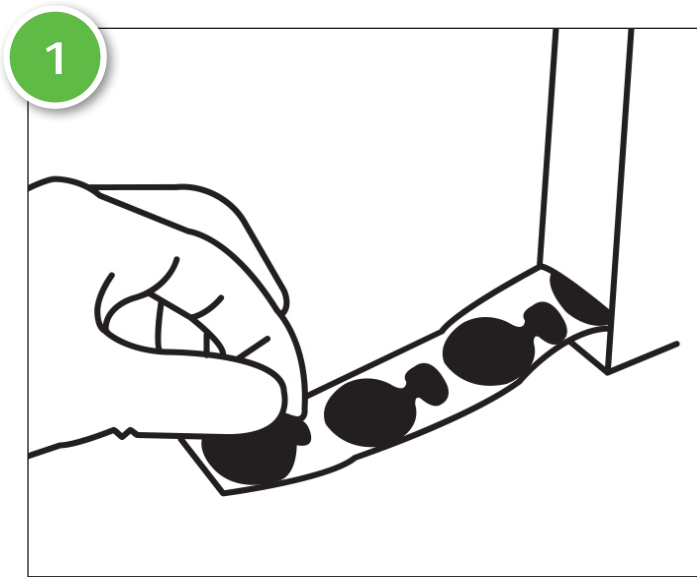

Remove Steri-Tamp® from liner.

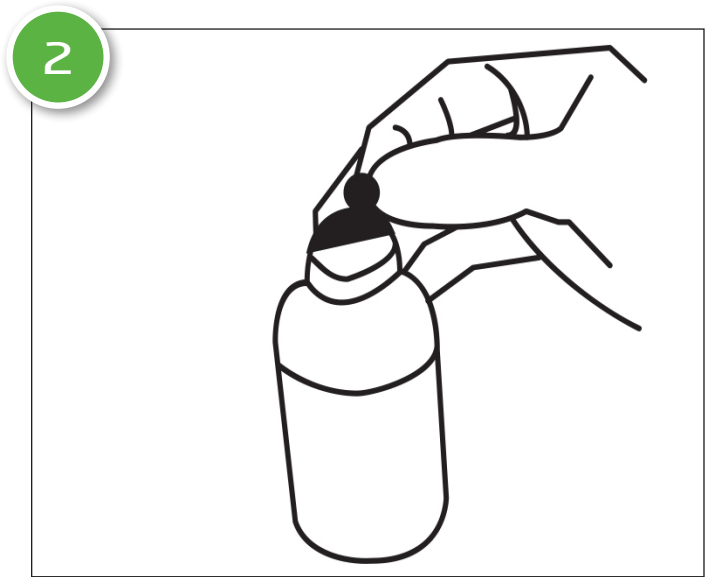

Use thumb and index finger to position registration mark over center opening on target area.

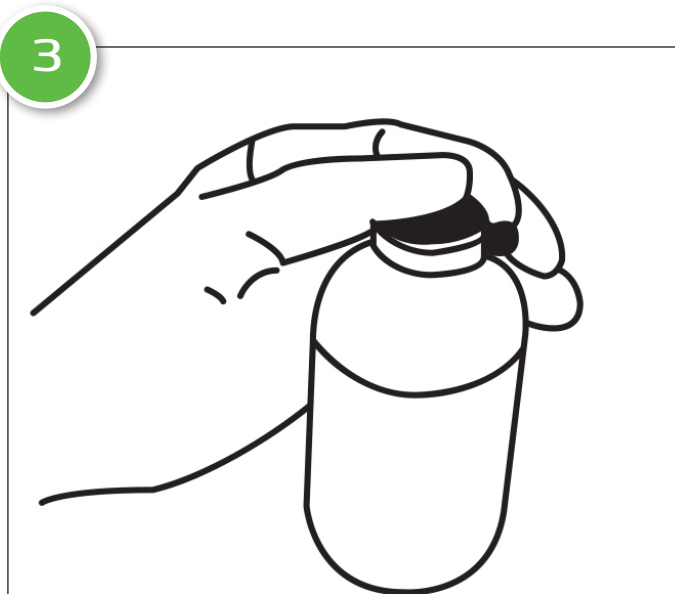

Press with thumb to firmly affix to top.

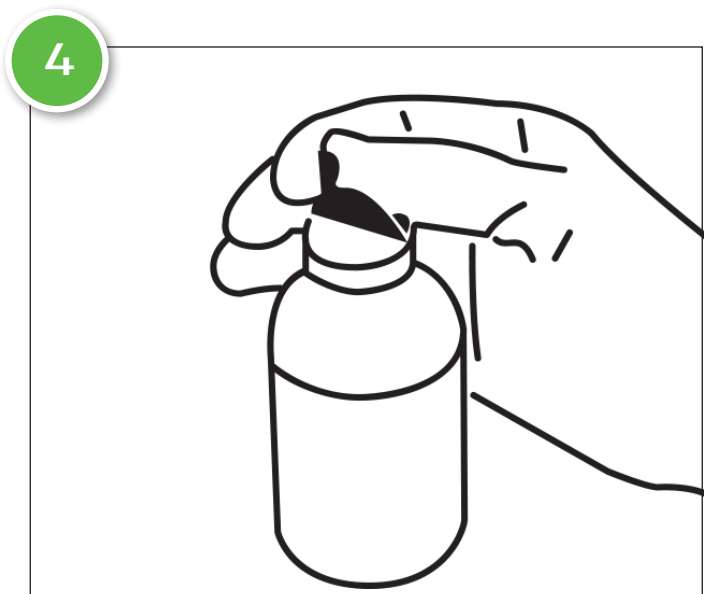

Upon removal, the top layer will separate from adhesive ring.

Steri-Tamp® may provide assistance in monitoring whether injectable products have already been used by indicating "OPENED" when the metalized layer is removed. Steri-Tamp® cannot be a substitute for good hospital practice and procedures. PDC Healthcare does not guarantee or warrant sterility of the medications with which Steri-Tamp® may be used.

STERILE: Contents have been GAMMA sterilized. The target area remains sterile until removed from liner.